



DEVELOPMENT VARIANCE PERMIT NO. DVP00369

THE BOARD OF EDUCATION OF SCHOOL DISTRICT NO. 68 (NANAIMO-LADYSMITH)
Name of Owner(s) of Land (Permittee)

Civic Address: 3135 MEXICANA ROAD

1. This development variance permit is issued subject to compliance with all of the bylaws of the municipality applicable thereto, except as specifically varied by this permit.
2. This permit applies to and only to those lands within the municipality described below, and any and all building structures and other developments thereon:

Legal Description:

LOT 1, SECTION 5, WELLINGTON DISTRICT, PLAN 16516

PID No. 000-446-009

3. The City of Nanaimo "SIGN BYLAW 1987 NO. 2850" is hereby varied as follows:

Section 3(22) General Provisions – to allow an animated sign generally as shown on Schedule C.

4. The permittee, as a condition of the issuance of this permit, shall develop the land described herein strictly in accordance with the following terms and conditions and provisions and in accordance with any plans and specifications attached hereto which shall form a part thereof.

Schedule A Location Plan

Schedule B Site Plan

Schedule C Elevation Drawing

5. If the permittee does not substantially commence the construction permitted by this permit within two years of the date of this permit, this permit shall lapse.

6. This permit prevails over the provisions of the bylaw in the event of conflict.
7. This permit is not a building permit nor does it constitute approval of any signage installation. Separate applications must be made for a building permit and sign permit.

CONDITIONS OF PERMIT

1. The proposed freestanding sign shall be located generally as shown on the Site Plan received 2018-OCT-15, as shown in Schedule B.
2. The proposed freestanding sign shall be constructed generally in accordance with the Elevation Drawings received 2018-OCT-15, as shown in Schedule C.
3. The LED/animated portions of the proposed sign are limited to static images only which must be displayed for a minimum display period of six seconds per image. The use of animation effects to transition from one static image to the next will be permitted. Maximum transition time is three seconds. Continuous video, flashing or scrolling type signs are not permitted.
4. The LED/animated portions of the proposed sign must include automatic dimming so that light intensity levels are automatically adjusted based on current weather conditions and the time of day.
5. The brightness level of the animated portions of the proposed sign shall not be more than 0.3 foot candles over ambient levels, as measured using a foot candle meter at a distance of 30m from the face of the sign.
6. The animated portions of the sign must be turned off between the hours of 10 p.m. and 6 a.m.

AUTHORIZING RESOLUTION PASSED BY COUNCIL
THE 17TH DAY OF DECEMBER, 2018.

Sky Snelgrove
Corporate Officer

December 20, 2018
Date

CH/In
Prospero attachment: DVP00369

Sky Snelgrove
Deputy Corporate Officer
City of Nanaimo

Development Variance Permit DVP00369
3135 Mexicana Road

Schedule A

LOCATION PLAN

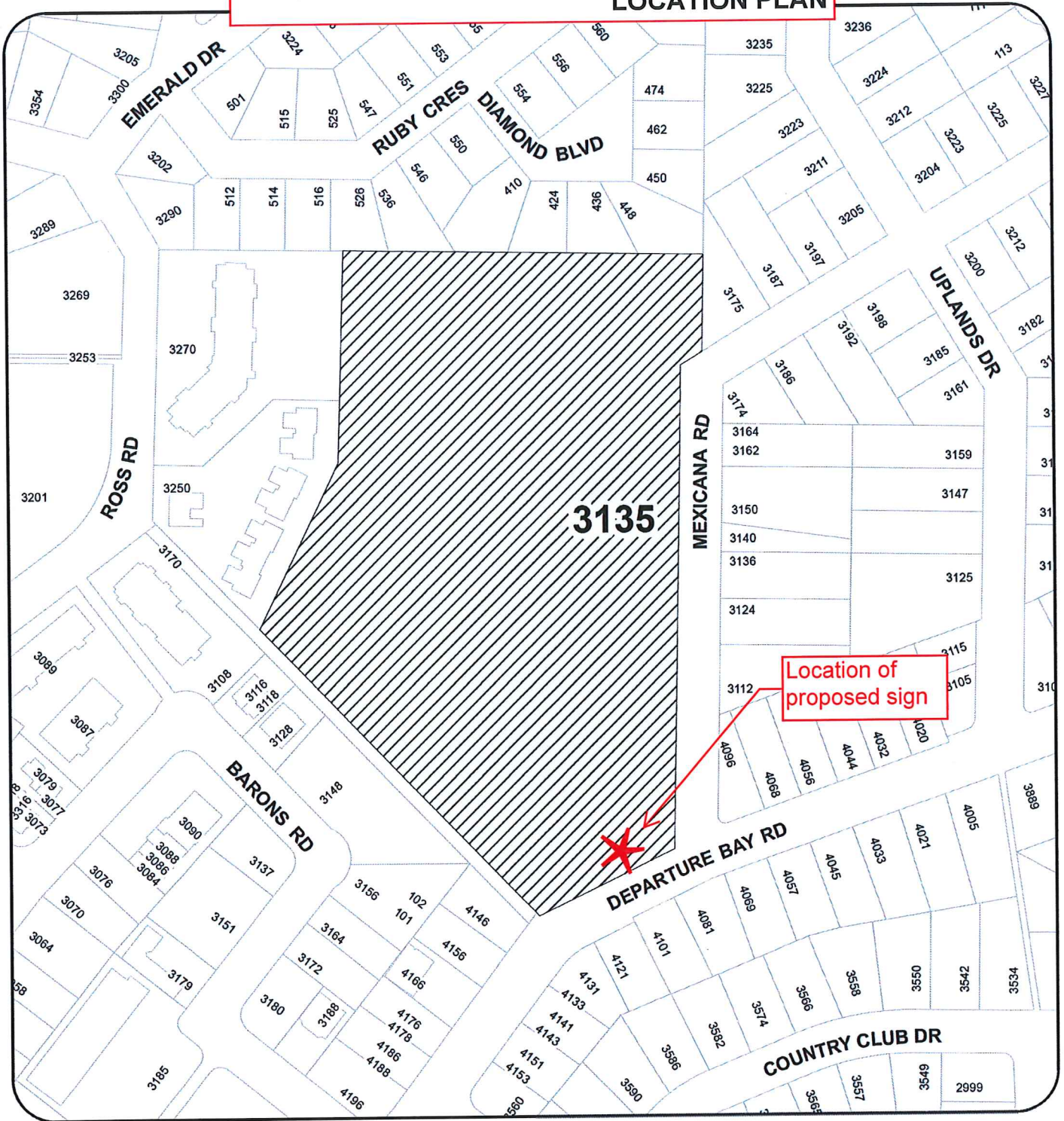

DEVELOPMENT VARIANCE PERMIT NO. DVP00369

LOCATION PLAN

Civic: 3135 MEXICANA ROAD
Legal Description: LOT 1, SECTION 5, WELLINGTON
PLAN 16516, WELLINGTON JR SECONDARY



Subject Property

Development Variance Permit DVP00369
3135 Mexicana Road

Schedule B

SITE PLAN

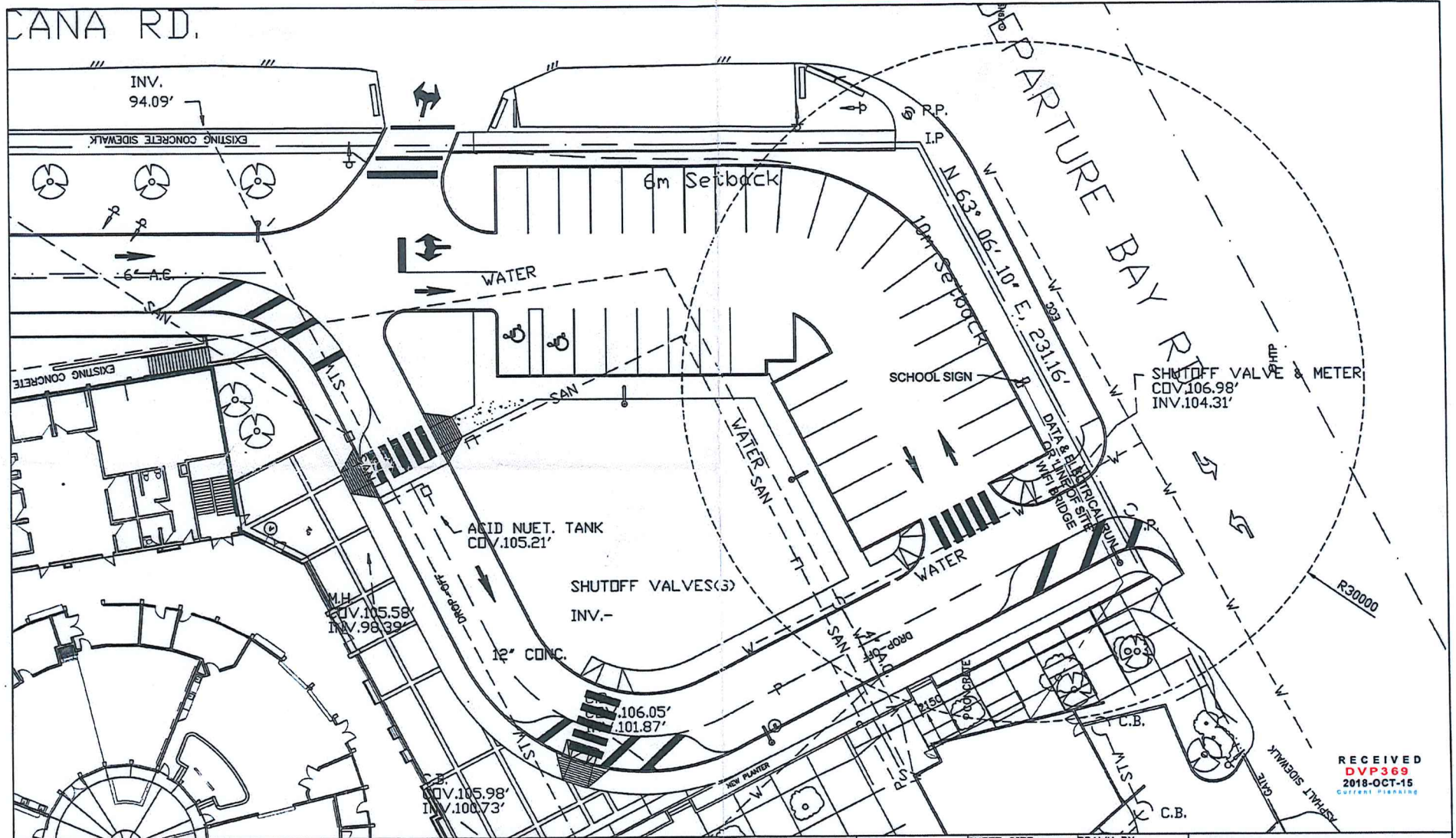

RECEIVED
DVP369
2018-OCT-15
CURRENT PLANNING



LOCATION
215 - WELLINGTON
SECONDARY SCHOOL

ADDRESS
33135 MEXICANA ROAD,
NANAIMO, V9T 2W8

DRAWING TITLE
PARTIAL SITE PLAN

DATE:
2018
SCALE:
1:300

SHEET SIZE:
B
SHEET #:
1 OF 1

DRAWN BY:
BB
APPROVED BY:
MR

THE NANAIMO-LADYSMITH SCHOOL DISTRICT
DOES NOT GUARANTEE THE ACCURACY OF THE
INFORMATION CONTAINED IN THESE DRAWINGS.
ALL DRAWING DETAILS AND MEASUREMENTS
SHOULD BE VERIFIED IF IMPORTANT.

ELEVATION DRAWING

Wellington Secondary School

Proposing Sign

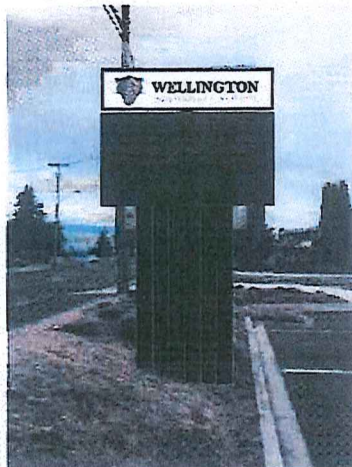

Existing Sign



EXISTING CONCRETE BASE TO REMAIN AS IS

Font Profile

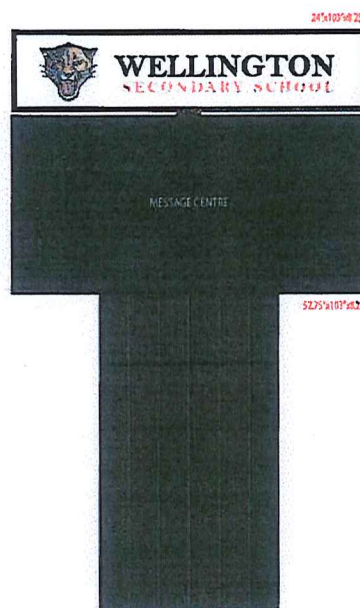

Side Profile

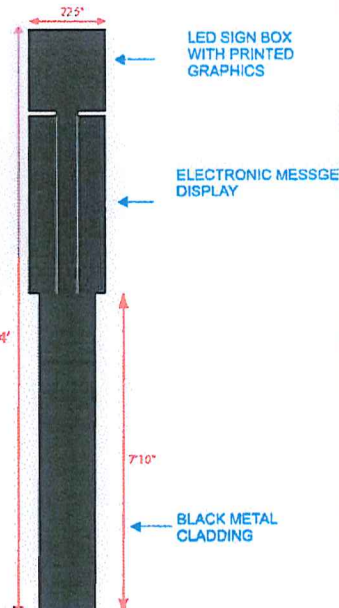

LED SIGN BOX WITH PRINTED GRAPHICS

ELECTRONIC MESSAGE DISPLAY

BLACK METAL CLADDING

PLEASE REVIEW AND LOOK OVER ARTWORK CAREFULLY

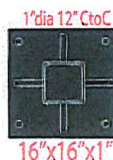

***Type of sign

Quantity: 1
Size:
Type: D/S Message display sign
Lighting: LED
Returns:
Face: 3/16" white polycarbonate
Mounted: POLE MOUNTED TO FOUNDATION

Colour Specifications

- ... Gold
- ... Black
- ... White
- ... Red

Note*
Footings to remain as is as per engineer foundation review by HAROLD ENGINEER

CONCEPT ONLY
Not finalized until confirmed by survey, permits and shop drawings
colours shown are for presentation purposes only

Hi-lite Signs
1586 Anderton Road Comox, BC
brandon@hlsigns.net
www.hlsigns.net



Hi-lite Signs is a CSA approved signage facility, Working with an approved facility that is certified by the Canadian standard association (CSA) Ensures that your illuminated signage is designed and made in accordance with the latest safety regulations

*All artwork, layout & designs are property of HI-lite Signs. Clients are subject to fees if copied or duplicated.

RECEIVED
DVP 369
2018-OCT-15
Current Planning